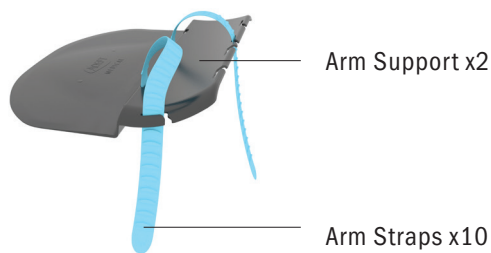

COMPONENTS | PRODUCT CODES

AM0640

ArmSure

**AM0610**

ArmSure + Shield

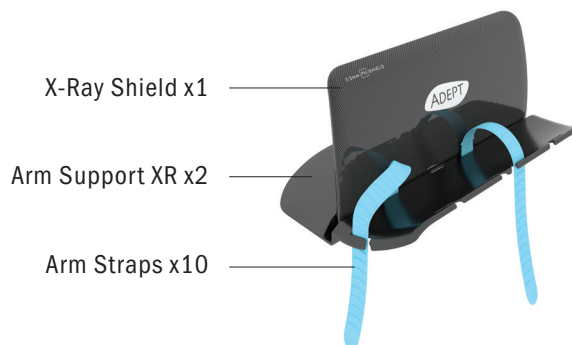

UNBOXING

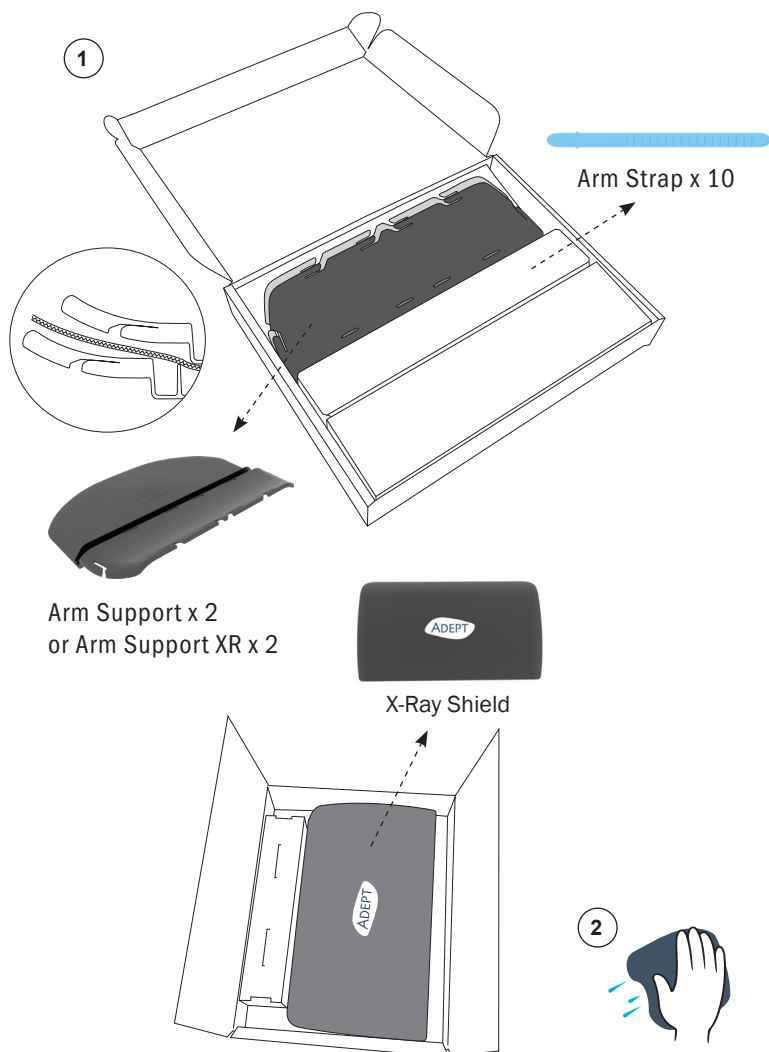

CLEANING



Disinfect and wipe clean before/after each use.

DO NOT USE any other sterilisation methods.



For an online training visit:
AdeptMedicalTraining.com



For service and repairs visit
AdeptMedical.com/repairs



For Approved Disinfectants PDF visit:
AdeptMedical.com/armsure



For Cleaning Instructions visit:
AdeptMedicalTraining.com/product-cleaning

**MANUFACTURER**

Adept Medical Ltd
2-6 McDonald St, Morningside
Auckland, New Zealand
www.adeptmedical.co.nz

**EC REPRESENTATIVE**

Emergo Europe
Prinsessegracht 20
2514 AP The Hague
The Netherlands



SETUP

1 Arm Support

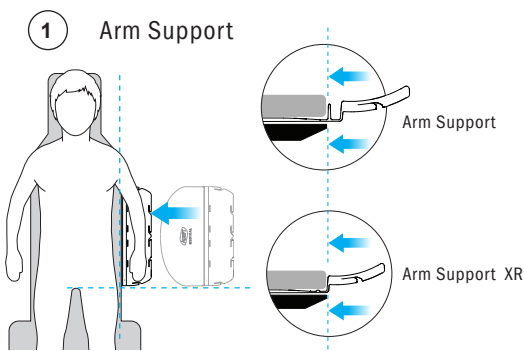

2 Strap Orientation

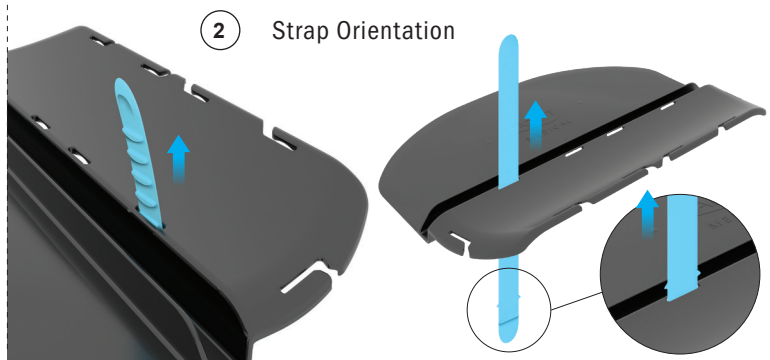

3 Securing patient's elbow

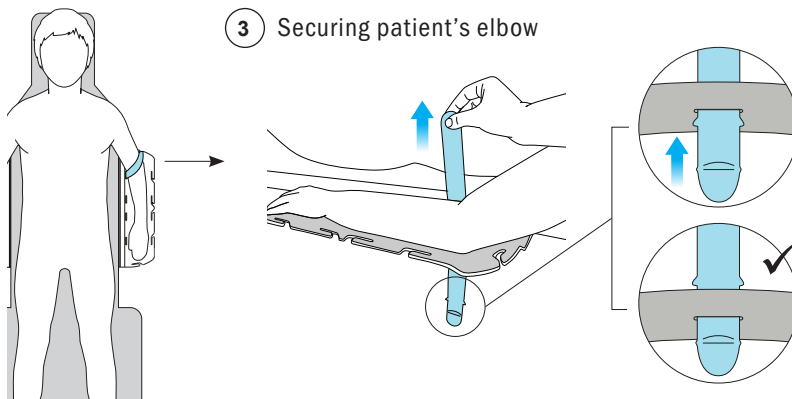

4

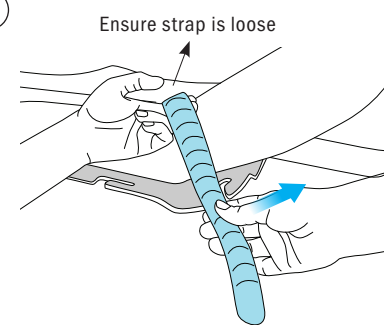

5

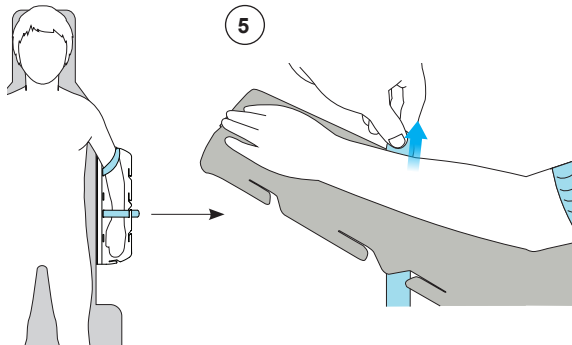

6

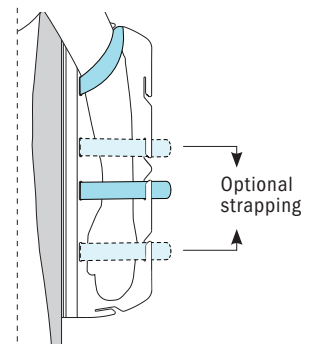
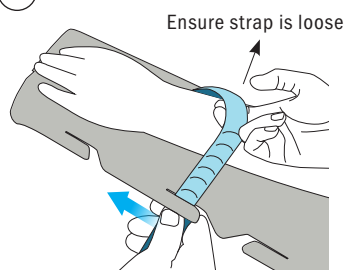

X-RAY SHIELD

ArmSure + Shield

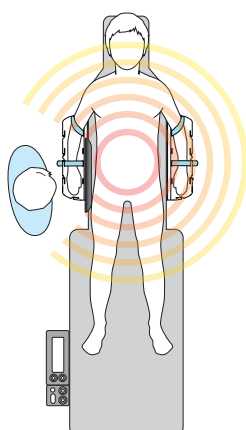

7



8

